



Townswell Gardens, Glassford, Strathaven
Offers Over £215,000

3 Bed Semi-Detached House



Whilst every effort is made to ensure the accuracy of these details, it should be noted that the measurements are approximate only. Floorplans are for representation purposes only and prepared according to the RICS Code of Measuring Practice by our floorplan provider. Therefore, the layout of doors, windows and rooms are approximate and should be regarded as such by any prospective purchaser. Any internal photographs are intended as a guide only and it should not be assumed that any of the furniture/fittings are included in any sale. Where shown, details of lease, ground rent and service charge are provided by the vendor and their accuracy cannot be guaranteed, as the information may not have been verified and further checks should be made either through your solicitor/conveyance. Where appliances, including central heating, are mentioned, it cannot be assumed that they are in working order, as they have not been tested. Please also note that wiring, plumbing and drains have not been checked.

Located within the new Borland Walk development by Lovell Homes lies this fantastic three-bedroom semi-detached villa. The property boasts generous living space over two levels and is presented to the market in excellent condition throughout.

On arrival at the property, you are welcomed by a spacious mono-block driveway. The rear garden grounds offer a patio area and a neat laid lawn. The grounds are enclosed by timber fencing making them secure for children and pets, whilst also offering excellent exposure to sunlight in the summer months. The grounds back onto scenic fields, offering picturesque views all year round.

Internally the accommodation comprises a reception hallway, a front-facing lounge that leads to a fully-fitted kitchen/dining area with patio doors that lead to the garden, and a downstairs w/c. On the upper level, there are three good -sized bedrooms with a master bedroom en-suite, and a modern three-piece family bathroom.

This incredible property benefits from luxury fittings throughout and is a perfect example of modern living.

Location

On the outskirts of Strathaven lies the sought-after village of Glassford. The village itself has a variety of local amenities such as a restaurant, a bar, a local shop, and a primary school, whilst the nearby village of Strathaven offers a further range of amenities such as restaurants, pubs, and shops, including a large Sainsbury's. Strathaven also offers a variety of sporting facilities, including bowling clubs, golf courses, public parks, and country walks. There are excellent road links to the surrounding towns of East Kilbride and

- Built By Lovell Homes
- Semi-Detached
- Three Bathrooms
- Three Bedroom
- Bright and Spacious

- Modern Living
- Luxury Fixtures & Fittings
- Garden
- Driveway
- Sought After Development

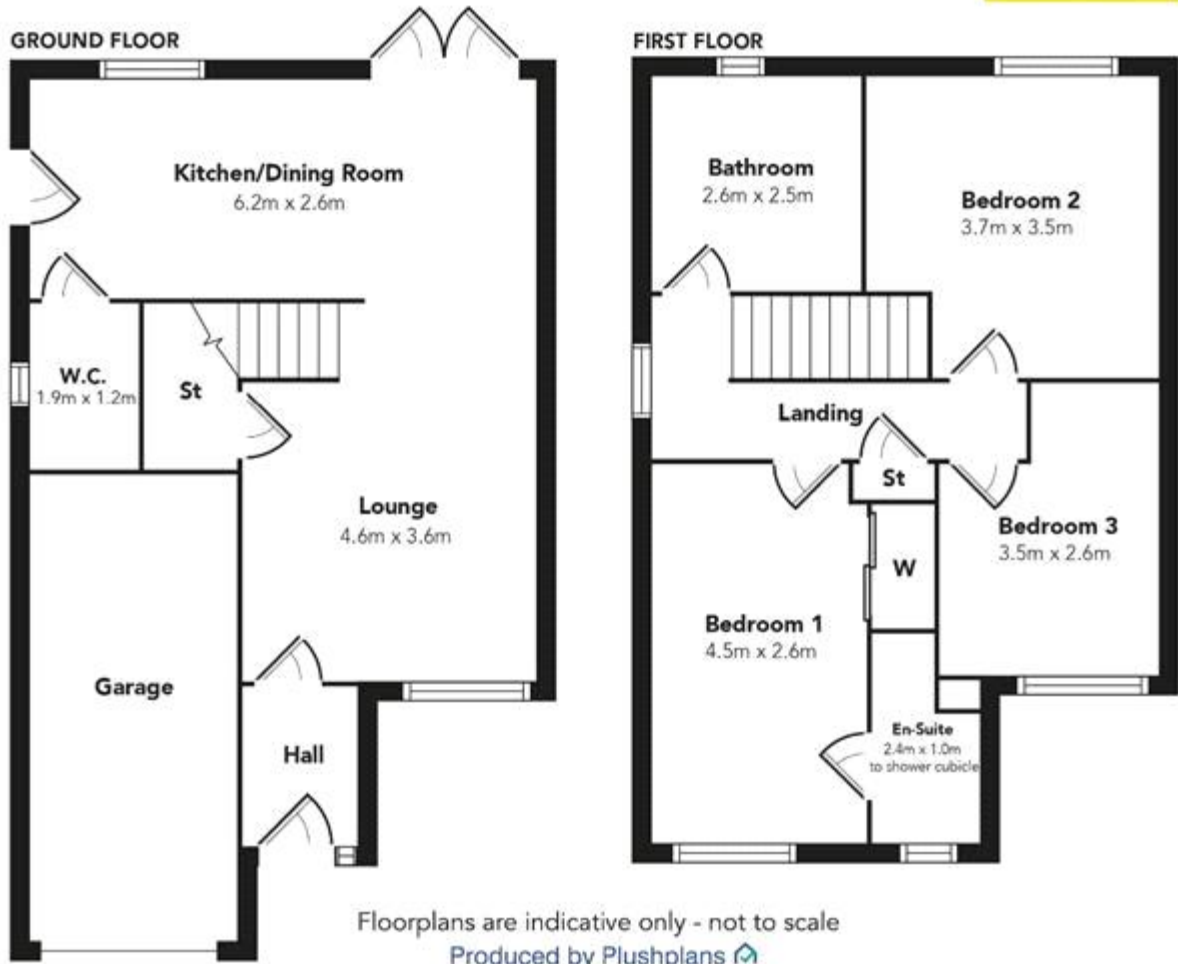

Viewing by appointment only
Momo Homes

40 Portland Place, Hamilton ML3 7JU

Tel: 01698 517044 Email: mail@momohomes.co.uk Website: www.momohomes.co.uk