



**65 Balcastle Crescent, Carlisle**  
**Offers Over £149,995**

3 Bed Semi-Detached House | Freehold



Whilst every effort is made to ensure the accuracy of these details, it should be noted that the measurements are approximate only. Floorplans are for representation purposes only and prepared according to the RICS Code of Measuring Practice by our floorplan provider. Therefore, the layout of doors, windows and rooms are approximate and should be regarded as such by any prospective purchaser. Any internal photographs are intended as a guide only and it should not be assumed that any of the furniture/fittings are included in any sale. Where shown, details of lease, ground rent and service charge are provided by the vendor and their accuracy cannot be guaranteed, as the information may not have been verified and further checks should be made either through your solicitor/conveyance. Where appliances, including central heating, are mentioned, it cannot be assumed that they are in working order, as they have not been tested. Please also note that wiring, plumbing and drains have not been checked.

Built by Persimmon Homes, lies this impressive three bedroom semi-detached villa located within a highly sought after development.

This fabulous home offers bright and spacious accommodation over two levels and has been upgraded by the current owner to a wonderful standard throughout.

On arrival at the property, there is a driveway allowing excellent parking facilities for approximately two vehicles. The garden grounds have been beautifully landscaped and offer a superb decking area, neat lawn and timber fencing. The grounds also benefit from exposure to natural sunlight which is perfect for the summer months.

Internally the accommodation comprises a reception hallway with downstairs W/C, front-facing lounge, fully fitted kitchen with dining area, three bedrooms with master en-suite and a three-piece bathroom.

- Built by Persimmon Homes
- Driveway
- Landscaped Gardens
- Master Bedroom En-suite
  
- Semi-Detached
- Stunning Interior
- Three Bathrooms
- Three Bedroom

**GROUND FLOOR**

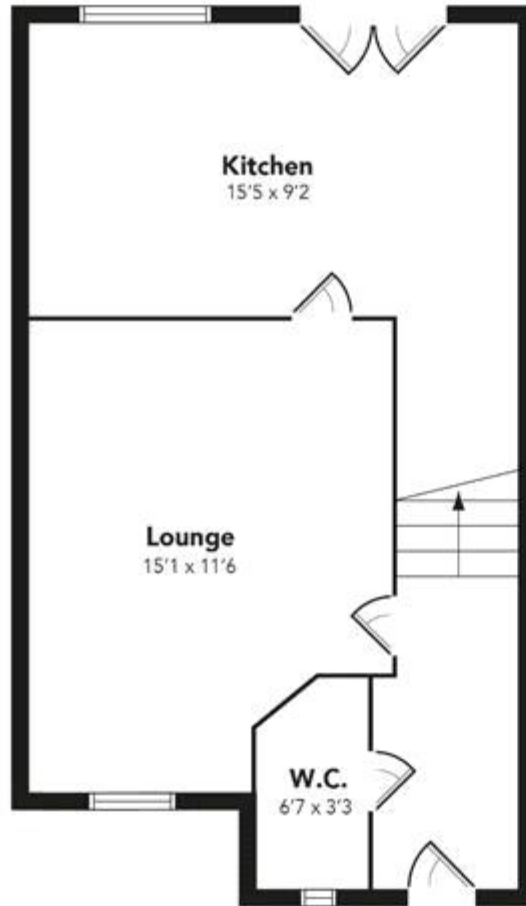

**FIRST FLOOR**

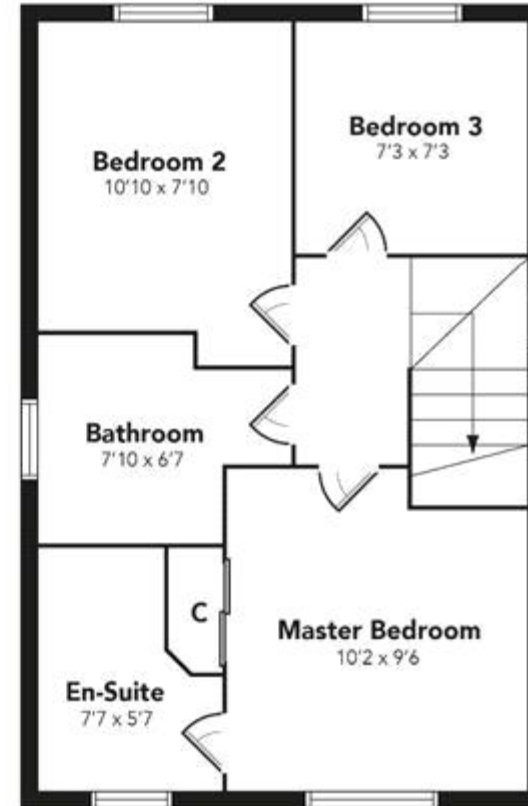

Floorplans are indicative only - not to scale  
Produced by Plush Plans Ltd 