



**Cherrytree Crescent, Larkhall**  
**Offers Over £105,000**

2 Bed Bungalow UNDER OFFER



Whilst every effort is made to ensure the accuracy of these details, it should be noted that the measurements are approximate only. Floorplans are for representation purposes only and prepared according to the RICS Code of Measuring Practice by our floorplan provider. Therefore, the layout of doors, windows and rooms are approximate and should be regarded as such by any prospective purchaser. Any internal photographs are intended as a guide only and it should not be assumed that any of the furniture/fittings are included in any sale. Where shown, details of lease, ground rent and service charge are provided by the vendor and their accuracy cannot be guaranteed, as the information may not have been verified and further checks should be made either through your solicitor/conveyance. Where appliances, including central heating, are mentioned, it cannot be assumed that they are in working order, as they have not been tested. Please also note that wiring, plumbing and drains have not been checked.

Seldom available two bedroom semi-detached bungalow set within a quiet address in one of Larkhall's most sought after locations.

The property benefits from a bright and spacious lounge, fully fitted kitchen, two bedrooms and a three-piece family bathroom. Further benefits include gas central heating and large driveway allowing excellent parking facilities for several vehicles.

The gardens are backing onto mature woodland and have been laid to lawn, offering excellent privacy and fantastic sunlight exposure in the summer months.

### Location

Cherrytree Crescent has long been popular with the discerning buyer and offers easy access to all local Larkhall facilities. These include quality schooling, shopping and train station. The adjacent motorway network also provides speedy commute to destinations lying further afield.

- Bungalow
- Close to amenities
- Driveway
- Fitted Bathroom
  
- Fitted Kitchen
- Private Gardens
- Two Bedrooms

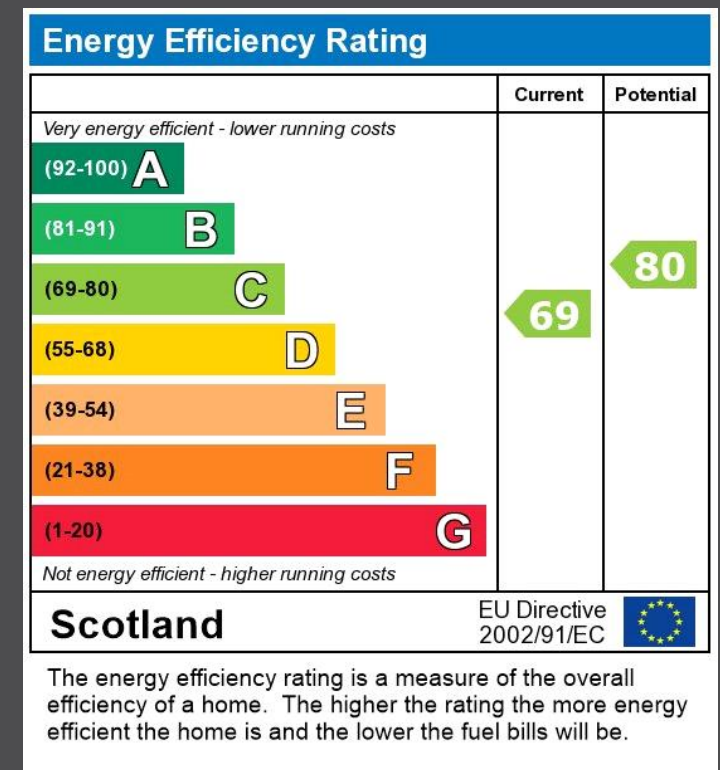

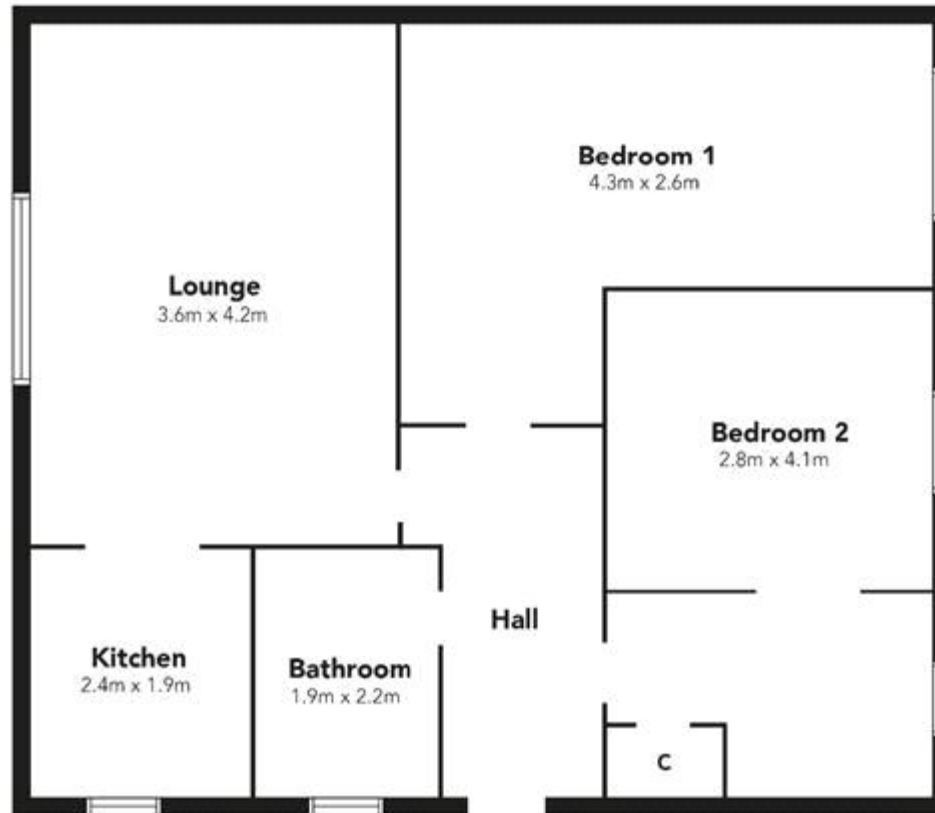

Floorplans are indicative only - not to scale  
Produced by Plush Plans Ltd 